

## SM32G Miniature Sensor

### Description

The sensor is made of alloy steel or stainless steel and features a low-profile diaphragm box structure. Laser sealing welding, compression bearing.

It is mainly applied in the fields of automated equipment such as hopper scales, belt scales, mixing plants, industrial robots, and automated filling systems, as well as in industrial measurement.

**Characteristics:** Strong anti-eccentric load capacity, high dynamic frequency, high precision, corrosion resistance, compact size and easy installation.



### Dimensions (In mm, 1mm=0.03937 inches)

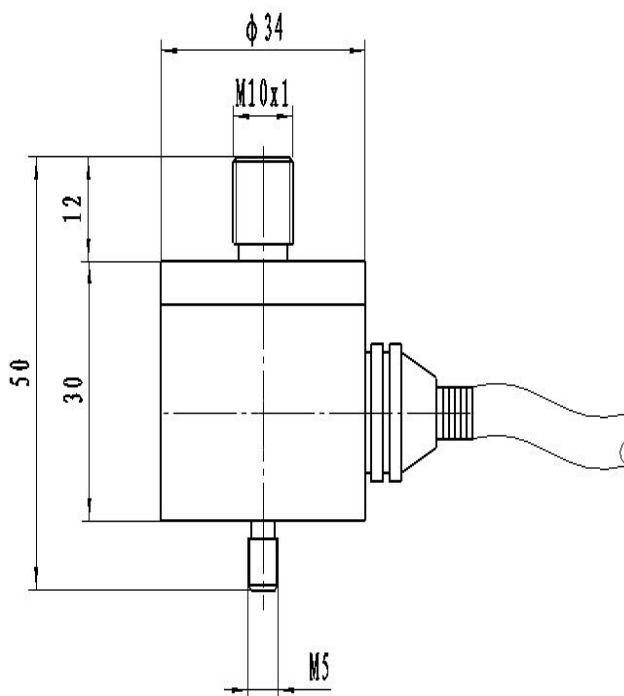

Circuit Diagram:

- Red: +input
- Blue: -input
- White: +output
- Yellow: -output

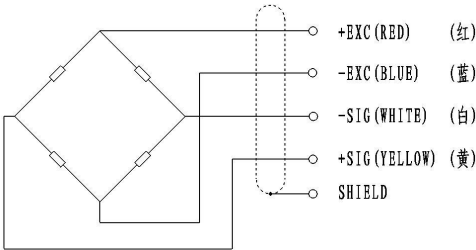

Specifica  
tion:

Type	Technical parameters
Nominal load range	5 ~ 100kg
Power supply	10~12 VDC
Zero balance	1.0±% of rated output
Analog output	2.0±0.015mV/V
Input resistance (Rlc)	380±5Ω (ohms)
Output resistance (Ro)	350±2Ω (ohms)
Insulation resistance	≥5000 MΩ (Mege-Ohms)
Class precision	0.05%FS
Effect of temperature	0.05%FS/10°C
Operating temperature	-40 ~ +85°C
Safe Load Limit	200% FS
Safety margin against yielding	300% FS
Safety margin against breakage	500% FS
Material material	High performance alloy steel or (chromium ratio>15% stainless steel)
Protection type	IP67