

## SM32C Miniature Sensor

### Description

The sensor is made of alloy steel or stainless steel and features a cylindrical integral structure. It is produced by introducing raw materials from the United States and the proprietary processing technology of the American BEAN Company. Silicone rubber sealing, compression bearing. It is mainly applied to the electronic force measurement system for tensile and compressive forces.

**Characteristics:** strong anti-eccentric load capacity, high precision, waterproof and oil-proof, corrosion-resistant, compact in size and easy to install.

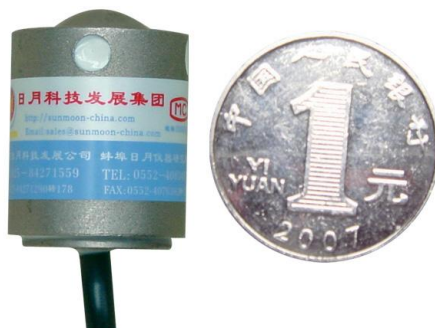

### Dimensions (In mm, 1mm=0.03937 inches)

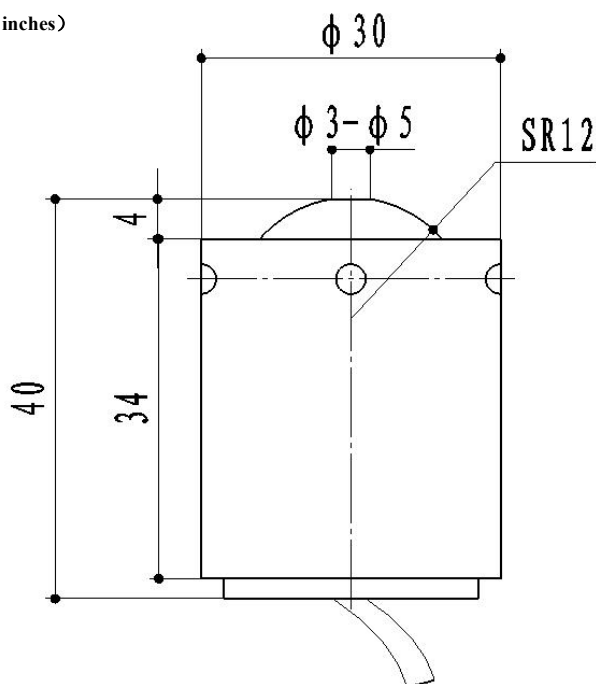

Circuit Diagram:

- Red: +input
- Blue: -input
- White: +output
- Yellow: -output

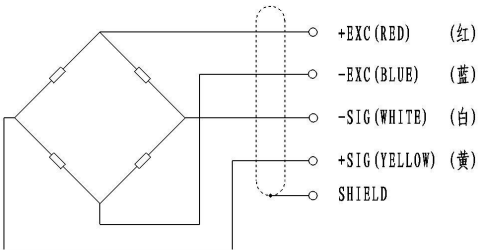

Specifica  
tion:

Type	Technical parameters
Nominal load range	1~5 t
Power supply	10~12 VDC
Zero balance	1.0±% of rated output
Analog output	2.0±0.015mV/V
Input resistance (R <sub>ic</sub> )	380±5Ω (ohms)
Output resistance (R <sub>o</sub> )	350±2Ω (ohms)
Insulation resistance	≥5000 MΩ (Mege-Ohms)
Class precision	0.05%FS
Effect of temperature	0.05%FS/10°C
Operating temperature	-40 ~ +85°C
Safe Load Limit	200% FS
Safety margin against yielding	300% FS
Safety margin against breakage	500% FS
Material material	High performance alloy steel or (chromium ratio>15% stainless steel)
Protection type	IP66